

AREA SCHEDULE

GROUND STOREY - TYPE B

| | |
|------------------|----------------------------|
| UNIT | 78,40m ² |
| COV. TERRACE | 6,80 m ² |
| SUB TOTAL | 85,20m² |
| DOUBLE CARPORT | 25,00m ² |
| TOTAL | 110,20m² |

3 BEDROOM & 2 BATHROOMS

TYPE

B

SOUTH

PROPOSED NEW TOWNHOUSE DEVELOPMENT ON STAND 4116 RYNFIELD EXT. 127

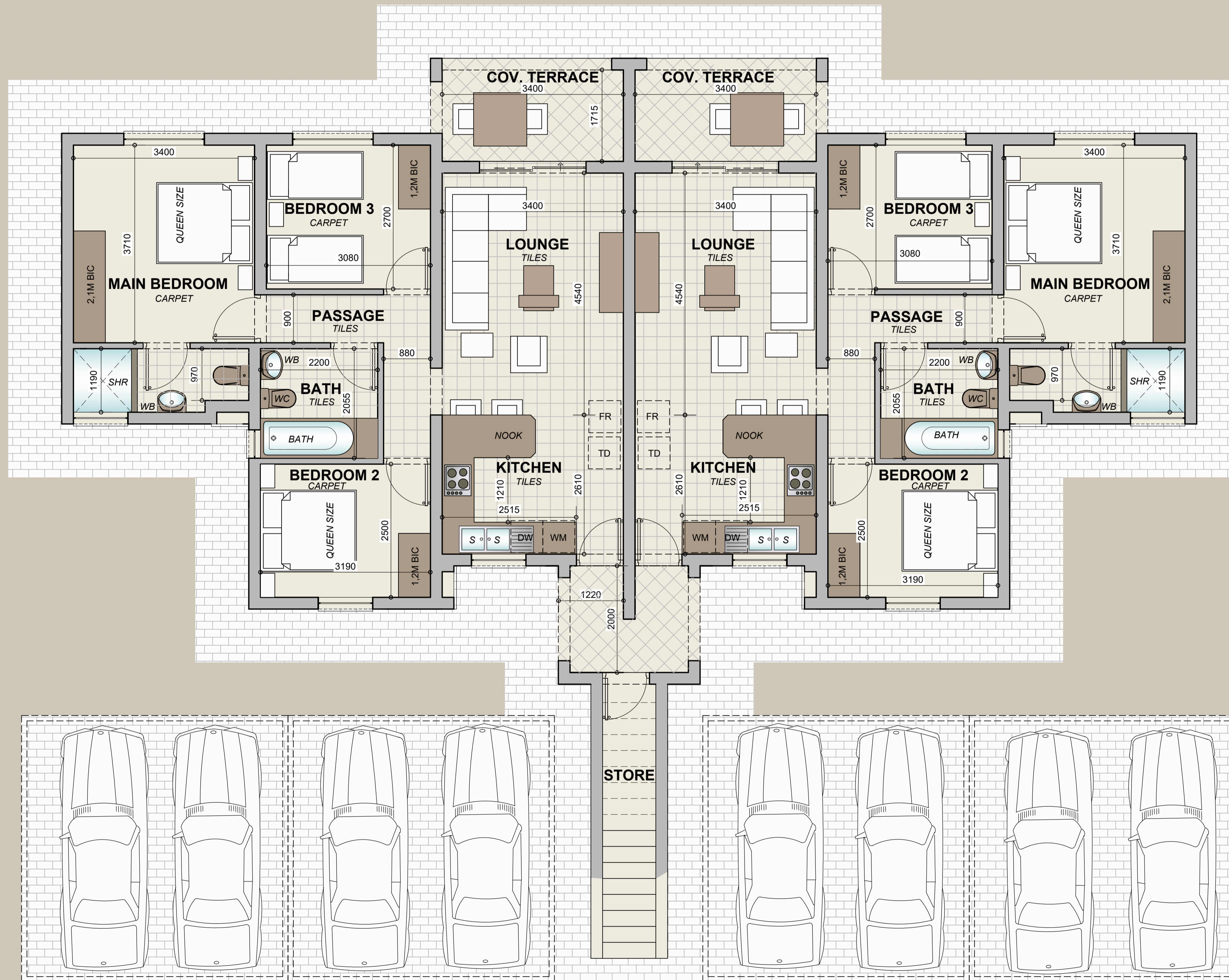

GROUND STOREY
NOT TO SCALE