

# Proposed New Townhouse Development On Stand 4167 Rynfield ext. 122

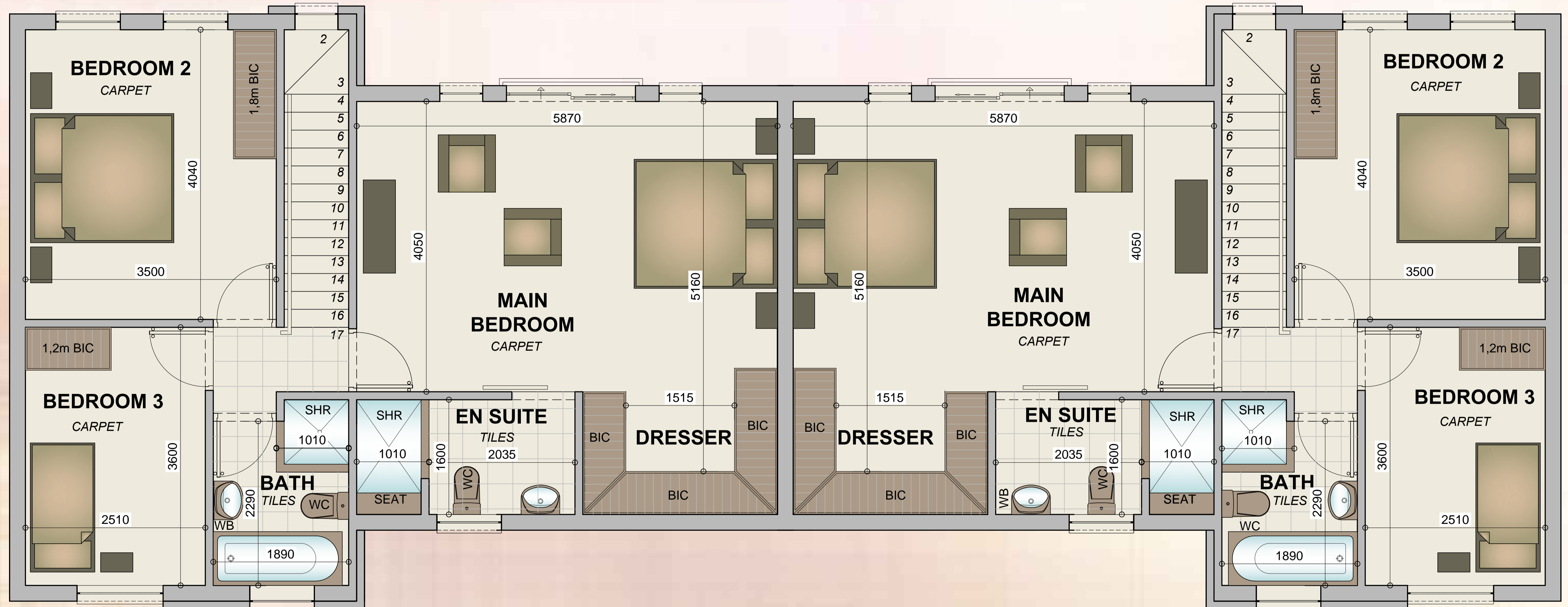
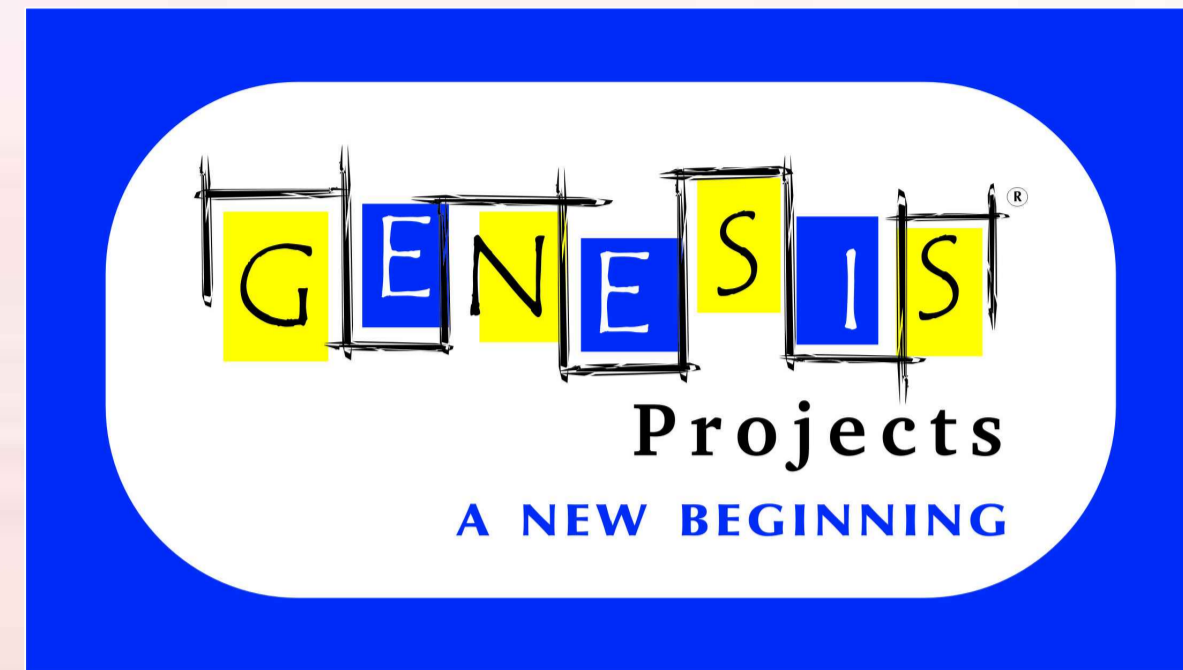

AREA SCHEDULE: SOUTH ENTRY	
GROUND FLOOR	40,54m <sup>2</sup>
DOUBLE GARAGE	36,42m <sup>2</sup>
FIRST FLOOR	73,23m <sup>2</sup>
<b>TOTAL</b>	<b>150,19m<sup>2</sup></b>

► First Storey

**SOUTH ENTRY**

**Type B**